

SABRE USB

The SABRE USB is a Bluetooth Low Energy (BLE) to CCID reader module that enables virtual credentials stored in a mobile device to be used within Windows, MAC, and Linux platforms. When plugged directly into any spare USB port in a computer, the SABRE USB enables a mobile device to be used for tap-in/ tap-out authentication with configurable activation ranges for auto-authenticating and disconnection, meaning your mobile device never needs to leave your pocket.



Key Features

CCID Compliant

Natively supported by Windows, MAC, and Linux with no requirement to install additional device drivers.

Onboard LED

Can be configured to display different colour LED when powered and in use.

Small Form Factor

Small form factor makes the SABRE USB suitable for mobile users with laptops.

Supports Multiple Emulation Modes

Can be firmware enabled to run as a smartcard reader or in keyboard wedge mode for custom applications.

Configurable Range

Can be configured for individual environments with adjustable connection and disconnection range.

How does it work?

When installed, the SABRE USB appears to the operating system as a CCID compliant smartcard reader. When a mobile device running the Safetrust Wallet application connects to the SABRE USB, the operating system natively accepts the virtual credential stored in the Wallet as a NIST SP 800-73 (PIV) secure smartcard. Authentication formats include certificates (SP800-73), smartcard emulation, or FIDO.

Installation

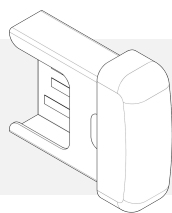

SABRE USB
module

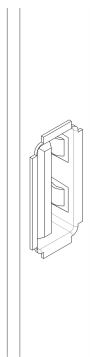

USB port
(computer)

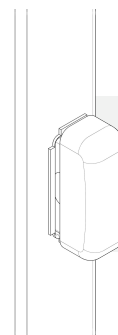

CCID compliant
smartcard reader

Simply install the SABRE USB into a free USB computer port and the operating system will recognize the device as a CCID compliant smartcard reader.

Specifications

- Mobile Operating Systems: Apple iOS 9.0 or later, Android 4.1 or later
- Desktop Operating Systems: Windows 7 and above, MacOS Version 10.11" El Capitan" or higher, Linux: REL 6, CentOS v7, Ubuntu 17.10 or above
- Smartcard emulation from a mobile device (Contact): ISO/IEC 7816 CCID compliant, T=0, T=1 protocol support, Communication speed up to 244, 105 bps (PPS, FI parameter)
- Smartcard emulation from a mobile device (Contactless): Support of ISO 14443 A and B (13.65 MHz) smartcards, ISO 14443 Part 1 to 4 complaint, MIFARE: Classic, DESFire, Communication speed: up to 848 Kbit/s
- LED: RGB (Tri colour)
- Hardware: BLE 2.400 GHz - 2.4835 GHz , CCID
- Network Access Credentials: NIST 800-73 certificate authentication, smartcard emulation, FIDO
- Power Source: 5 VDC
- Bluetooth Range: 1 to 100 ft (.30 to 30 m)
- Encryption: AES 256, x.509, NIST 800-73
- Dimensions: External to USB port: 0.59" x 0.20" x 0.20" (15 x 5 x 5 mm)
Total size: 0.71" x 0.3" x 0.28" (18 x 7.5 x 7 mm)
- Operating Conditions: Temperature [°C]: 0-65
Humidity [%]: 5-90 (non condensing)
- Regulatory Compliance: Functional: FCC, IC, CE, RCM
Environmental: RoHS2, WEEE
- Warranty: 2 Years (limited warranty, review warranty for complete details)

*Technical data subject to change without notice. To order, contact sales@safetrust.com or visit www.safetrust.com/shop.